

**PLAN CADASTRAL**  
**U.A.T. PIPIRIG, JUD. NEAMT, SECTOR NR. 15**  
 SCARA 1:1000  
 SISTEM DE PROIECTIE STEREO-70

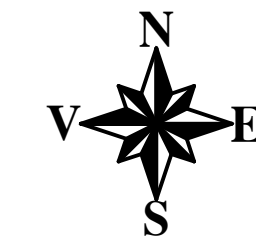
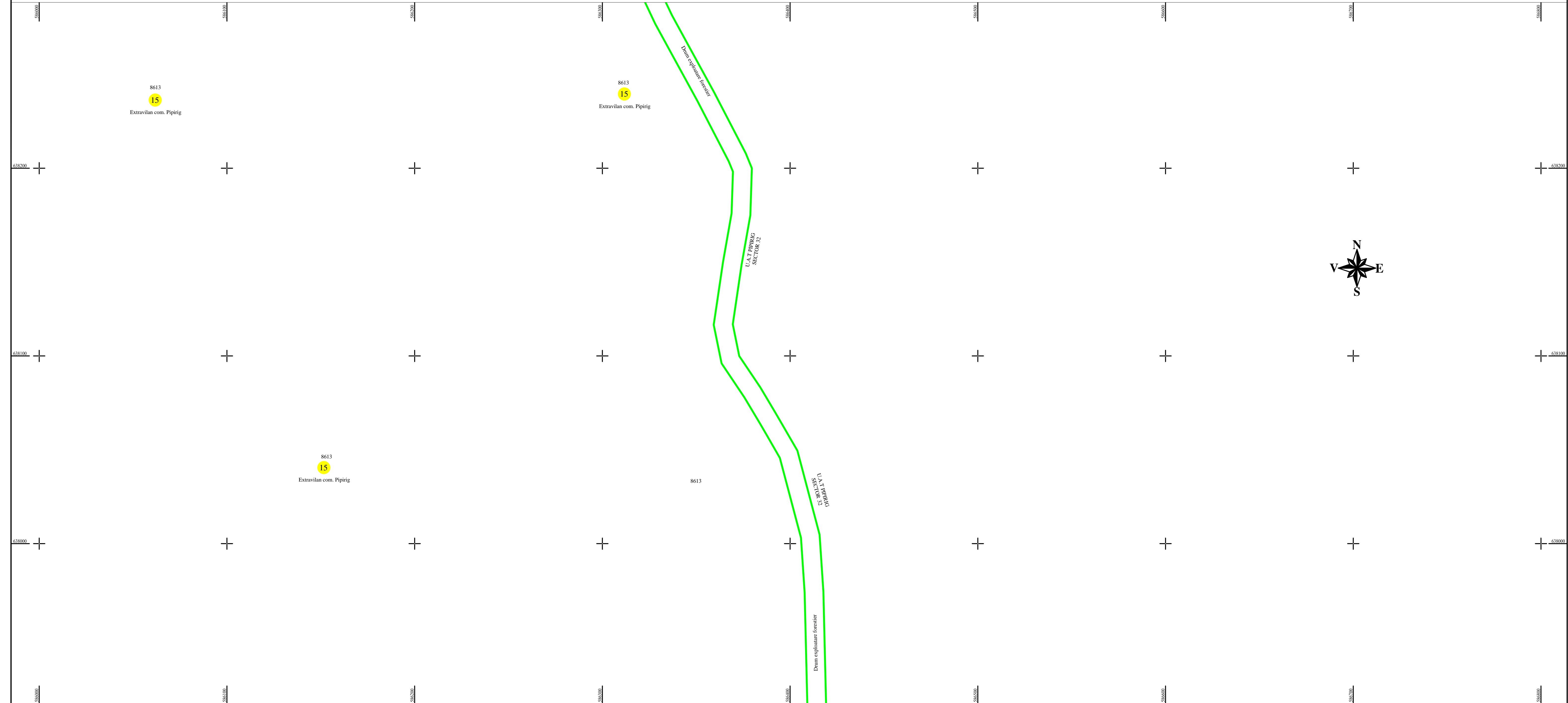

**SCHEMA DE RACORDARE A PLANSELOR**

|    |    |    |    |    |    |    |    |
|----|----|----|----|----|----|----|----|
| 1  | 2  | 3  | 4  | 5  | 6  | 7  |    |
| 8  | 9  | 10 | 11 | 12 | 13 | 14 | 15 |
| 16 | 17 | 18 | 19 | 20 | 21 | 22 | 23 |
|    |    |    | 24 | 25 | 26 |    |    |
|    |    |    | 27 | 28 |    |    |    |
|    |    |    | 29 | 30 |    |    |    |

**LEGENDA:**

|                   |           |
|-------------------|-----------|
| Sector cadastral  |           |
| Limita imobil     |           |
| Limita intravilan |           |
| Limita UAT        |           |
| Numar sector      | <b>15</b> |
| ID imobil         | 722       |

**DISPUNEREA SECTOARELOR CADASTRALE**

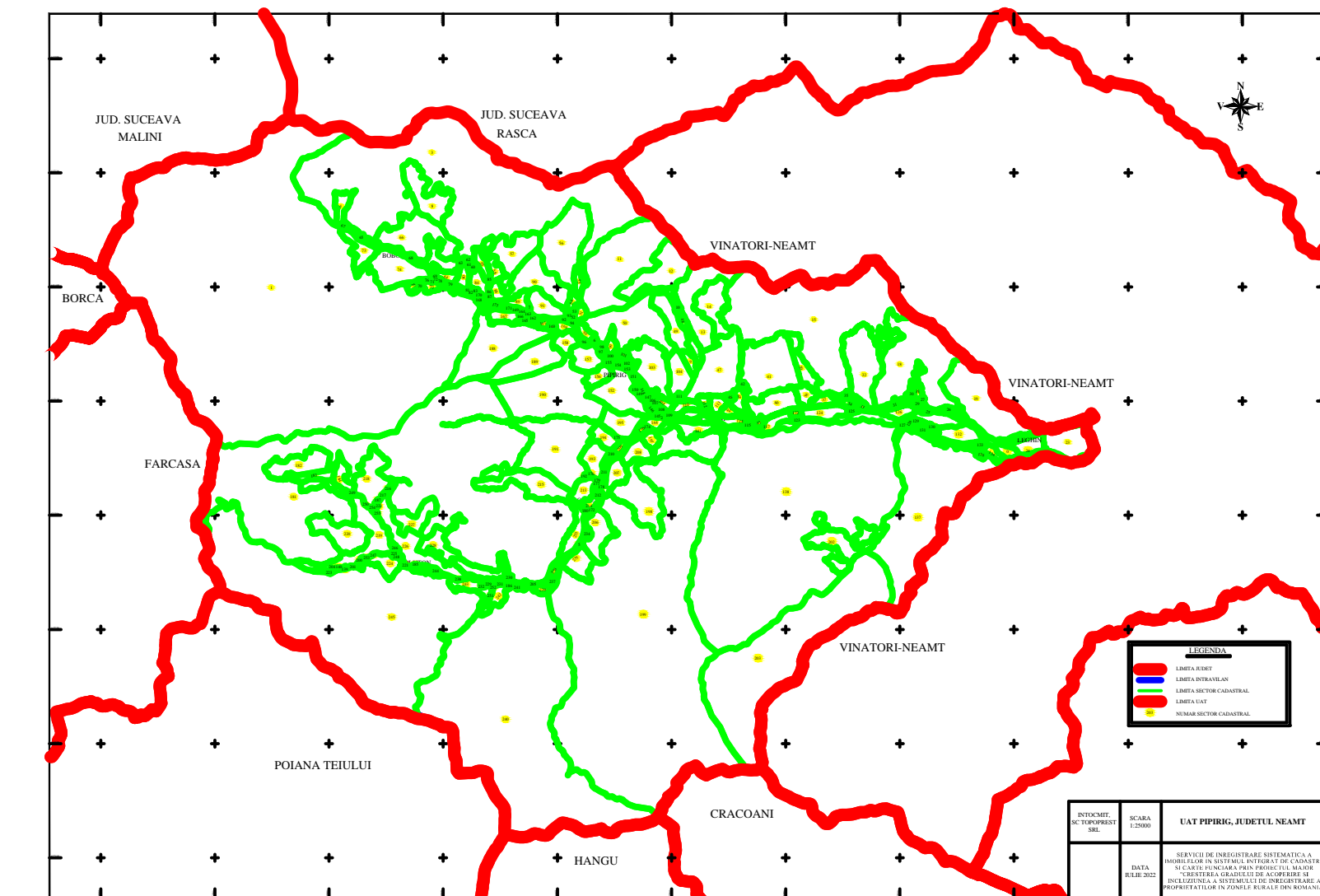

Întocmit:  
**SC TOPOPREST SRL**

Data întocmirii:  
**APRILIE 2023**

Lucrări de înregistrare sistematică UAT PIPIRIG - DOCUMENTE TEHNICE ALE CADASTRULUI SPRE PUBLICARE  
 SC TOPOPREST SRL - document semnat electronic  
 SC TOPOPREST SRL - CERTIFICAT DE AUTORIZARE CLASA I SERIA RO-B-J NR. 1804  
 MIRCEA AFRASINEI - CERTIFICAT DE AUTORIZARE CATEGORIA D SERIA RO-B-F NR. 0976